

## STEP 1:

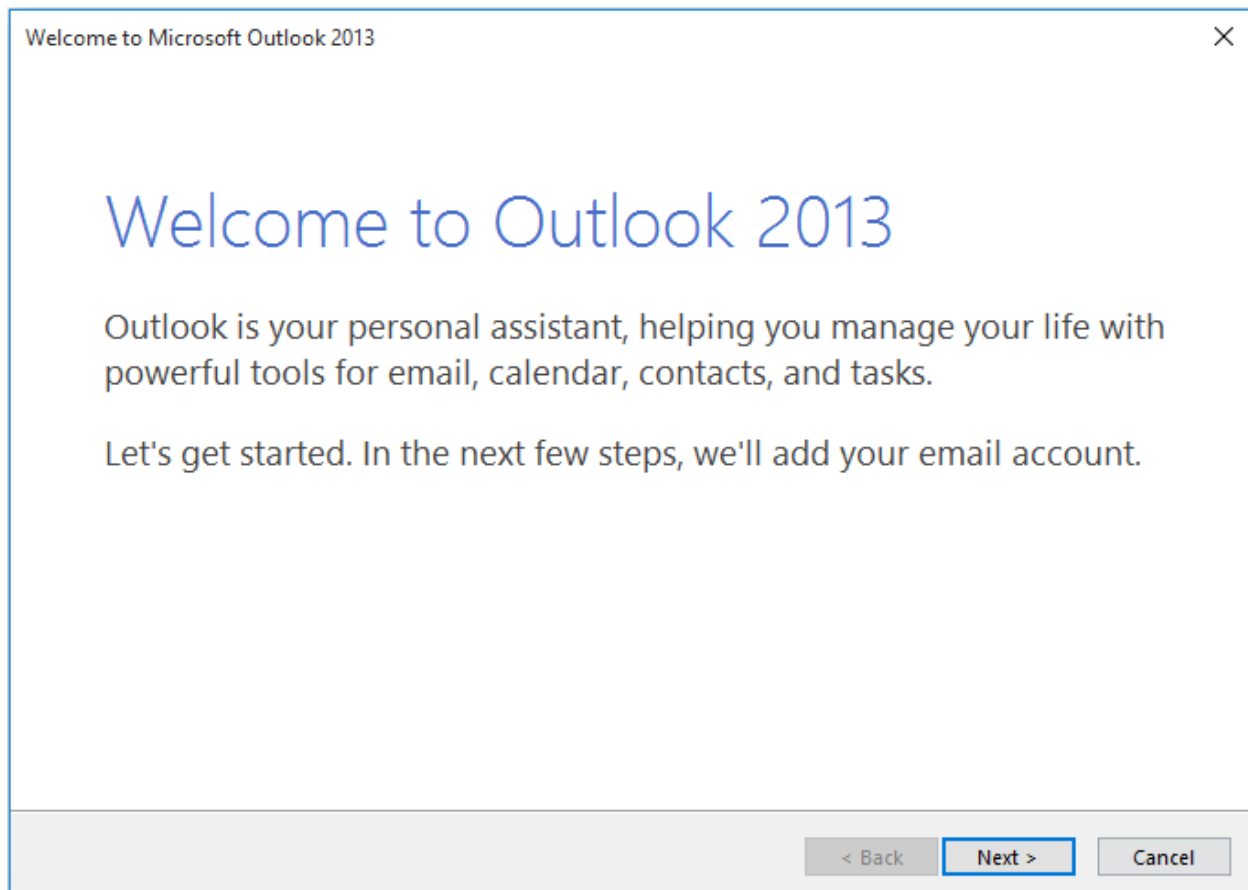

## STEP 2:

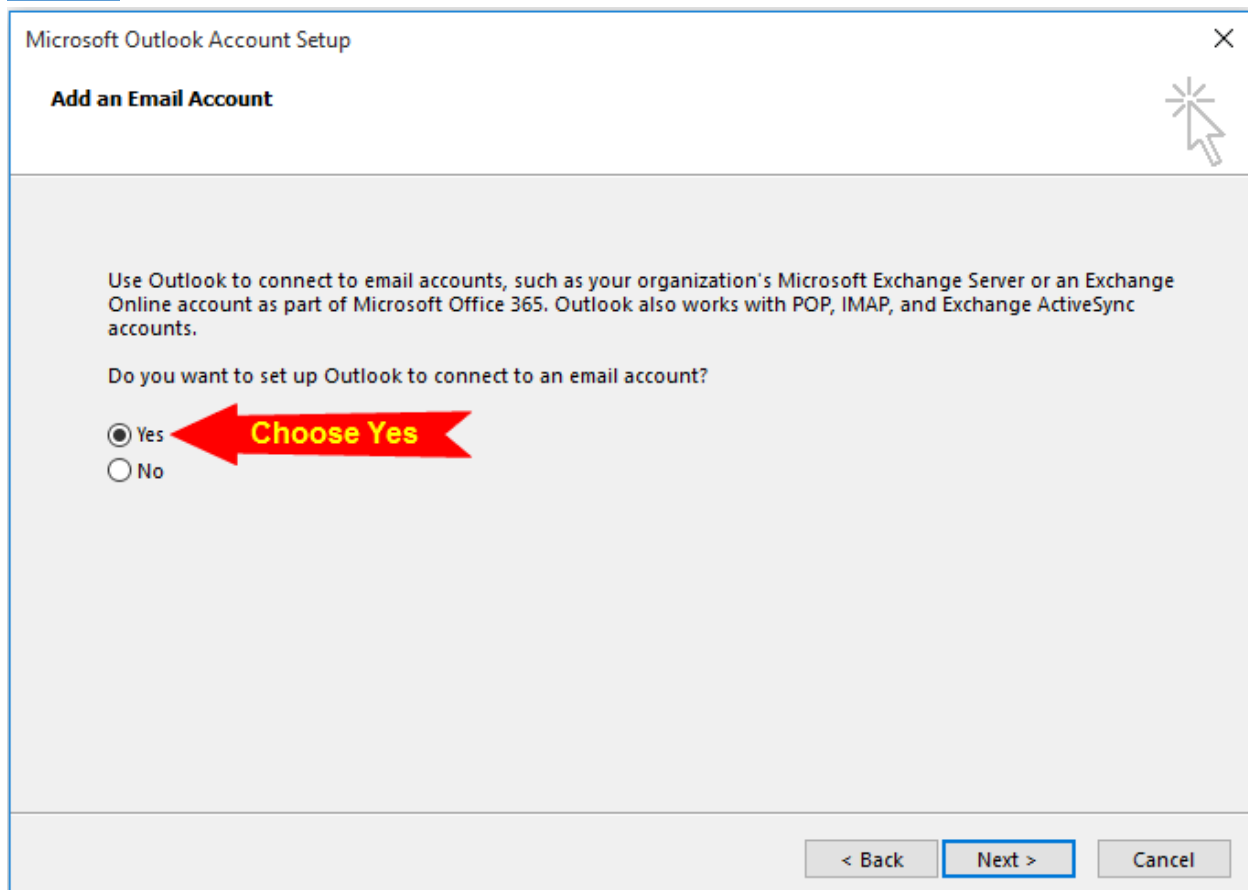

### STEP 3:

Add Account ✕

**Auto Account Setup**  
Manual setup of an account or connect to other server types.

E-mail Account

Your Name:   
Example: Ellen Adams

E-mail Address:   
Example: ellen@contoso.com

Password:

Retype Password:   
Type the password your Internet service provider has given you.

**Manual setup or additional server types**

**Choose this option here and press Next**

### STEP 4:

Add Account ✕

**Choose Service**

**Microsoft Exchange Server or compatible service**  
Connect to an Exchange account to access email, calendars, contacts, tasks, and voice mail

**Outlook.com or Exchange ActiveSync compatible service**  
Connect to a service such as Outlook.com to access email, calendars, contacts, and tasks

**POP or IMAP**  
Connect to a POP or IMAP email account

**Choose this option here and press Next**

## STEP 5:

**Add Account**

**POP and IMAP Account Settings**  
Enter the mail server settings for your account.

**User Information**

Your Name:  **Your Name here**

Email Address:  **Your Email Address here**

**Server Information**

Account Type:  **Fill this information same as written here**

Incoming mail server:

Outgoing mail server (SMTP):

**Logon Information**

User Name:  **Your Email Address here**

Password:  **Your Password here**

Remember password

Require logon using Secure Password Authentication (SPA)

**Test Account Settings**

New Outlook Data File

## STEP 6

**Add Account**

**Internet E-mail Settings**

**Select this Tab**

General **Outgoing Server** Advanced

My outgoing server (SMTP) requires authentication

Use same settings as my incoming mail server

Log on using

User Name:

Password:

Remember password

Require Secure Password Authentication (SPA)

Log on to incoming mail server before sending mail

## STEP 7:

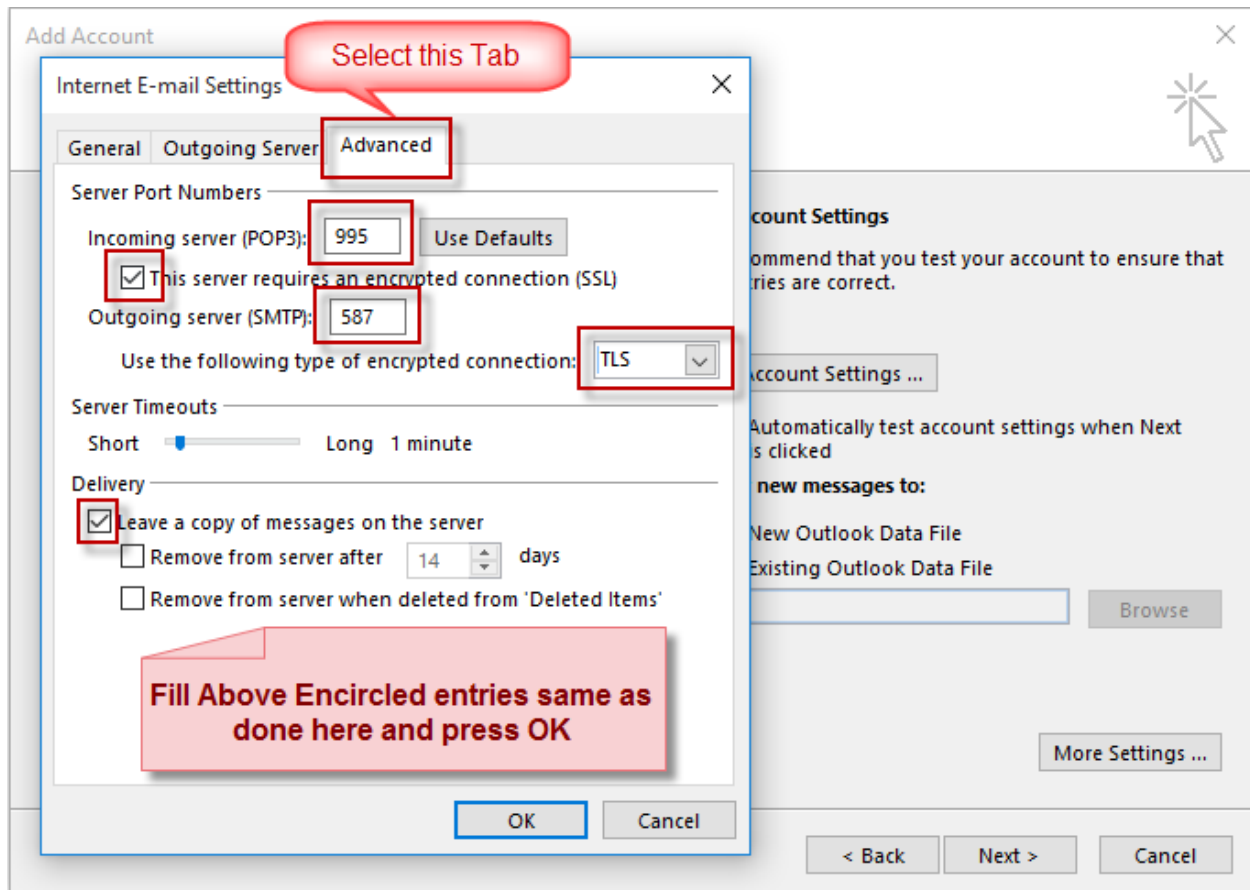

**STEP 8:** Finally click “Next” button to finalize Email setup.